

B12

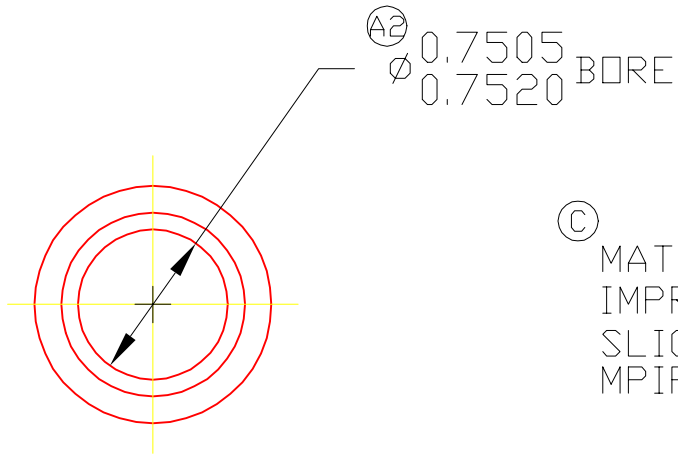

(C) MAT'L SAE 841 SINTERED BRONZE
 IMPREGNATED WITH #30 TURBINE OIL
 SLIGHT OIL FILM ALLOWABLE
 MPIF CT-1000-K26

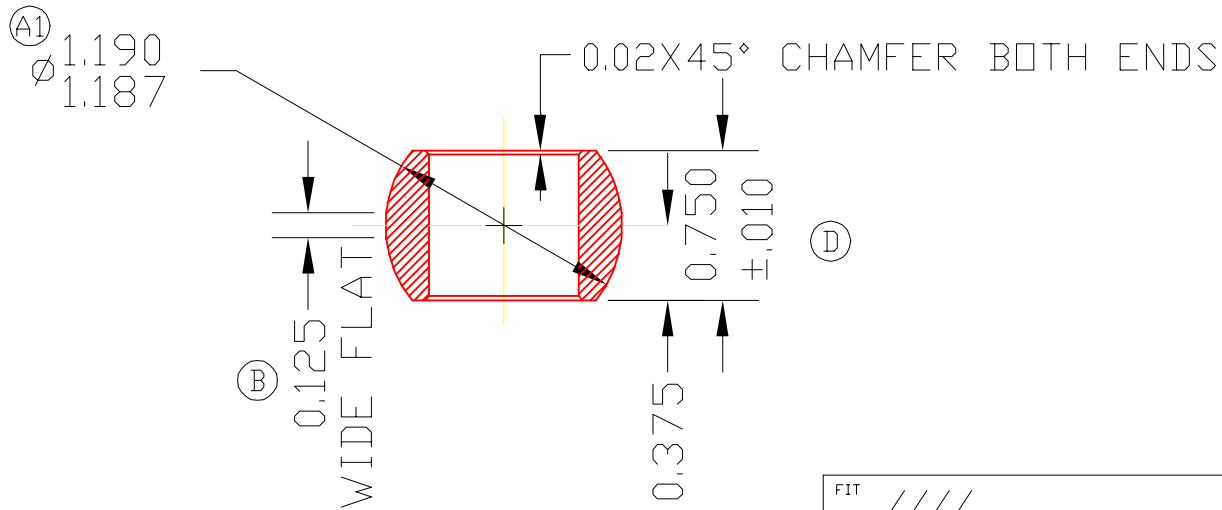

DET	PART NUMBER	DESCRIPTION	AMT
A	TRIANGLE MANUFACTURING CO. OSHKOSH, WI.		
	NAME BRG. BALL PM		
	USED IN B SERIES		
	DATE 1-28-64	PART NO.	
	DRAWN LML	B12	
	CHECKED SP		
	SCALE 1 / 1		

FIT	////
PLATING	////
MATERIAL	SEE NOTE*
ALL DIMS ± 0.02 UNLESS SPECIFIED	

CHANGE LEVEL
D 03-04-02